

# The 1527 Alley Load Duplex.

**HOLTHOMES**  
Built for the Pacific Northwest



SQUARE FEET:

**1,527**



STORIES:

**3**



BEDROOMS:

**4**



BATHS:

**2.5**



GARAGE CAPACITY:

**2**

FIND HOME: [holthomes.com/floorplans](https://holthomes.com/floorplans)

# HOLT HOMES

Built for the Pacific Northwest

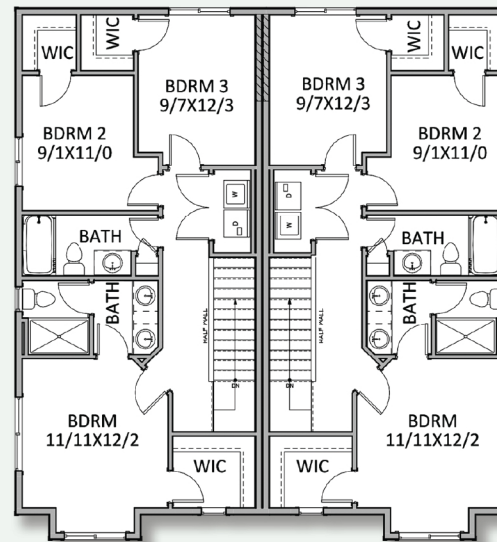
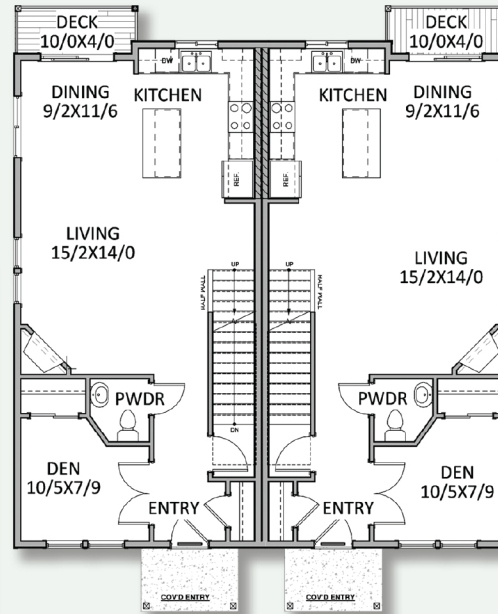
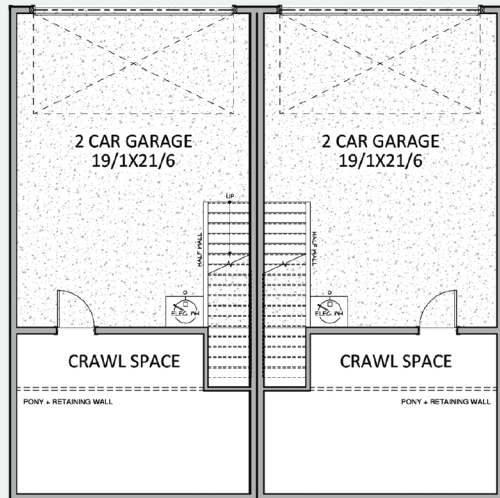

SQUARE FEET: **1,527**



STORIES: **3**



BEDROOMS: **4**



BATHS: **2.5**



GARAGE CAPACITY: **2**

\*All floor plan specifications are subject to change without notice and should be verified with your Holt Representative prior to purchase.

CCB: 133921  
WAWI882ML

To learn more about this floor plan please visit our website [holthomes.com/floorplans](http://holthomes.com/floorplans).

 Equal Housing  
Opportunity